

ROBERT NOBLE  
ARCHITECT  
A.I.A.  
106 EAST 5<sup>th</sup> Ave.  
ROME, GA 30161  
PH: (706) 295.2700  
FX: (706) 295.2063

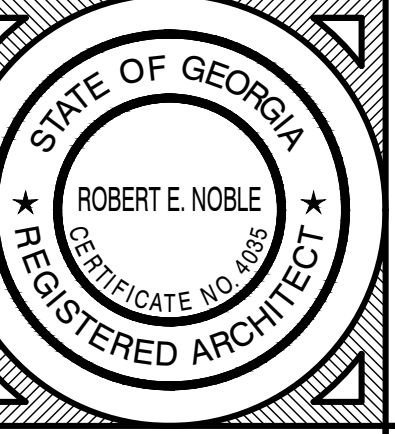

CITY OF ROME  
ROME GEORGIA RESIDENCE  
601 BROAD STREET  
ROME, GEORGIA 30161

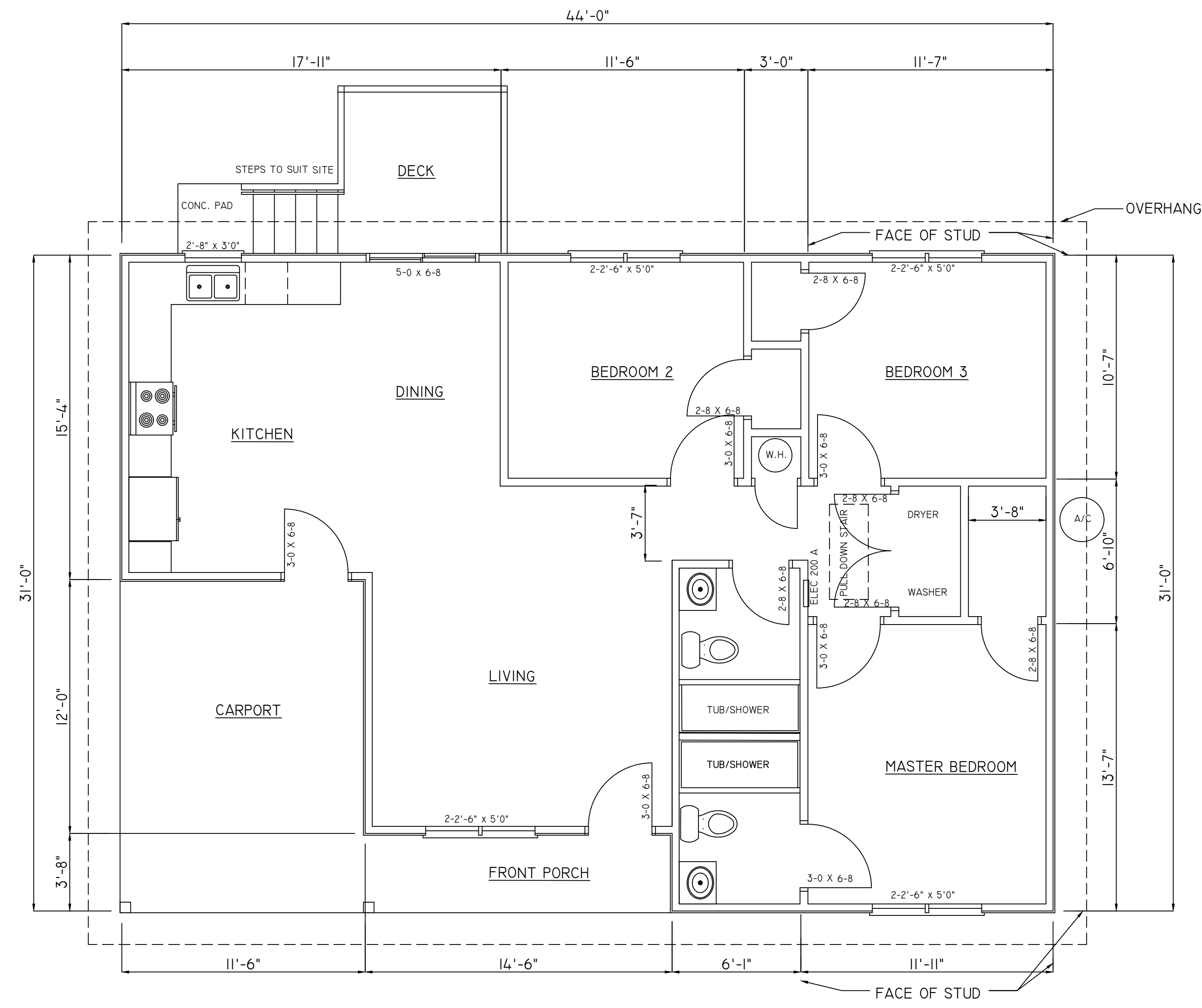

**NOTE:**  
Visitability Requirements for CHIPBuild 2018 OCGA 8-3-172:

1. One "No Step Entry" through 36 inch door
2. On first floor:
  - a. Each interior door is at least a standard 32-inch door, unless the door provides access only to a closet of less than 15 square feet in area;
  - b. Each hallway has a width of a least 36 inches and is level, with ramped or beveled changes at each door threshold;
  - c. Each bathroom wall is reinforced for potential installation of grab bars;
  - d. Each electrical panel or breaker box (located inside on first floor), light switch, or thermostat is not higher than 48 inches above the floor; and
  - e. Each electrical plug or other receptacle is at least 15 inches above the floor.

**FLOOR PLAN**

SCALE: 1/4" = 1'

FLOOR PLAN

PROJECT # 2005  
DRAWN BY: R.E.N.  
DATE: 03-19-20  
REV. DATE:

**A1.1**